

TWIN AND SINGLE MID LINE FRESH WATER URNS

HEAT EXCHANGE BREWING SYSTEM

Project

Date

Models

Twin Models:

7443

7446

74410

Single Models:

7413

7416

74110

Electric

Item #

Quantity



Features

- **Fresh Water Brewing**

Water used for brewing is fresh water that is heated in a coiled, nickel-plated, copper heat exchange tube inside the urn. As water passes through the heat exchanger coil it is heated to optimum brew temperature.

- **Durable Construction**

All A.I.S.I. type 304, 18-8 stainless steel.

- **Constant Brew Temperature**

Brew temperature varies less than 5°F (3°C) throughout spray over.

- **Automatic Coffee Agitation**

Thoroughly mixes brewed coffee immediately after spray over is completed.

- **Automatic refill of water compartment**

Water compartment automatically refills and reheats as needed.

- **Low water cutoff System**

Protects heating elements from burn out, at start-up or in operation.

- **Velvet Smooth Spray Arm**

Teflon® coating on spray arm piston prevents liming and insures smooth operation. Positive "stops" on spray arm for operator ease.

Easy to operate:

- **Fully Automatic – Push Button Operation**

Simply load brew basket with coffee, align spray arm over basket lid hole and press brew start button.

- **Adjustable Bypass valve on spray arm**

Enables proper coffee extraction even with variable water conditions.

- **Dial Thermometer with color-marked brew zone.**

- **Thermostat adjustable from front**

Knob on thermostat has four marked positions: Brew, Hold, Night Standby and Off.

Serviceable:

- **Drain valve in bottom.**

- **Control drawer with all electronic components is accessible from side.**

TWIN AND SINGLE MID LINE FRESH WATER URNS

HEAT EXCHANGE BREWING SYSTEM

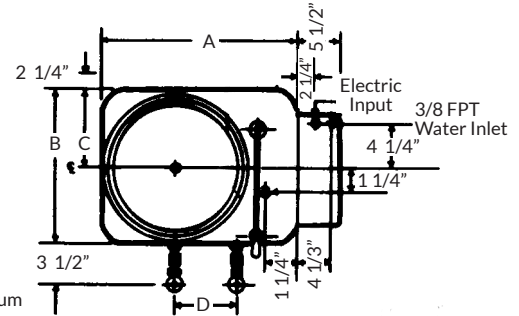
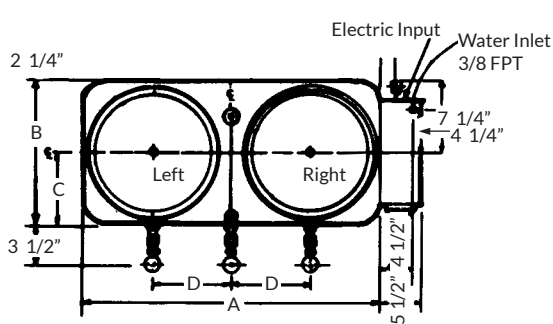

Faucet clearance 8" minimum

	MODEL	COFFEE CAPACITY (EACH LINER)	MAXIMUM GALLONS/HOUR*	NUMBER OF 5 OZ. CUPS PER HOUR
TWIN	7443	3 gal.	25	625
	7446	6 gal.	32	800
	74410	10 gal.	42	1050
SINGLE	7413	3 gal.	14	450
	7416	6 gal.	32	800
	74110	10 gal.	42	1050

* Based on spraying over amount of water equal to capacity of liner.

MODEL	A	B	C	D	WORK HEIGHT	OVERALL HEIGHT
7443	30-1/2"	15-1/4"	7-5/8"	7-3/4"	21-5/8"	27-1/8"
7446	34"	16-3/4"	8-3/8"	8-5/8"	27-5/8"	33-1/8"
74410	34"	16-3/4"	8-3/8"	8-5/8"	27-5/8"	34-5/8"
7413	18"	15-1/4"	7-5/8"	5-1/2"	21-5/8"	27-1/8"
7416	21"	16-3/4"	8-3/8"	7-5/8"	27-5/8"	33-1/8"
74110	21"	16-3/4"	8-3/8"	7-5/8"	27-5/8"	34-5/8"

BREW BASKET SELECTION CHART

Brews	3 Gal.	6 Gal.	10 Gal.	1/2 Batch on 3 Gal.	1/2 Batch on 6 Gal.	1/2 Batch on 10 Gal.
Part. No.	BB3	BB6	BB810	BB3-1.5	BB6-3	BB810-6

Note: All SS Permanent Filter Brew Basket with SS woven wire cloth bottom is available. Filter paper is available from our stock. See price list.

Military Specifications - Marine Modifications

Twin and single automatic urns MIL-U-43263E or latest specification.

Available modified for marine (shipboard) use; no spillage of liquid with 15° list in any plane, and other requirements. Contact factory for detailed quotation and data.

Multiple Faucet Options

- Opt. DS-1 2C, 1W Back/Rear, No Gauges
- Opt. DS-2 1C, 1W Back/Rear, with Gauges
- Opt. DS-3L 2C, 1W Back/Rear, No Gauges, w/ selecta-flow

Fast Fill Options

- Opt. 56 Jug Fill Funnel and Chain (18" long)
- Opt. 57 Gravity Jug Fill Hose Assembly (6' long)

Electric Heat

Specify electric service desired. Standard is dual voltage 120/240V or 120/208V single phase 3 wire (neutral wire required). Watts and amps as shown.

Note: A ground wire must be provided in addition to wire service shown. All service includes terminal block hook-up.

MODEL	120/240 VOLT		120/240 VOLT		240 VOLT		120/208 VOLT		480 VOLT		
	1-PHASE	3 WIRE	1-PHASE	3 WIRE	3-PHASE	3 WIRE	3-PHASE	4 WIRE	3-PHASE	4 WIRE	
	KW	AMPS	KW	AMPS	SPECIFY OPT. 21B		SPECIFY OPT. 21A		SPECIFY OPT. 21C		
				KW	AMPS	KW	AMPS	KW	AMPS	KW	AMPS
7443	7	29	5.5	25	10.5 [†]	25	8	22	12	14	
7446	11.5	48	8.5	41	12	29	11.5	31	12	14	
74410	15	63	11.5	54	15	36	15	42	12	14	
7413	7	29	5.5	25	10.5 [†]	25	8	22	12	14	
7416	11.5	48	8.5	41	12	29	11.5	31	12	14	
74110	15	63	11.5	54	15 [*]	36	15	42	12	14	

* No extra charge

Or Opt. 2200P step down transformer.

[†] Separate 3 wire 120V cord and plug for control circuit.



Grindmaster™ 4003 Collins Lane, Louisville, KY 40245 USA

Tel: +1.502.425.4776 / 800.695.4500 (USA & Canada only) • Fax: +1.502.425.4664 • www.grindmaster.com

© 2020 Grindmaster™ PRINTED IN USA | 0112 Form # AM-912-04